

Top view

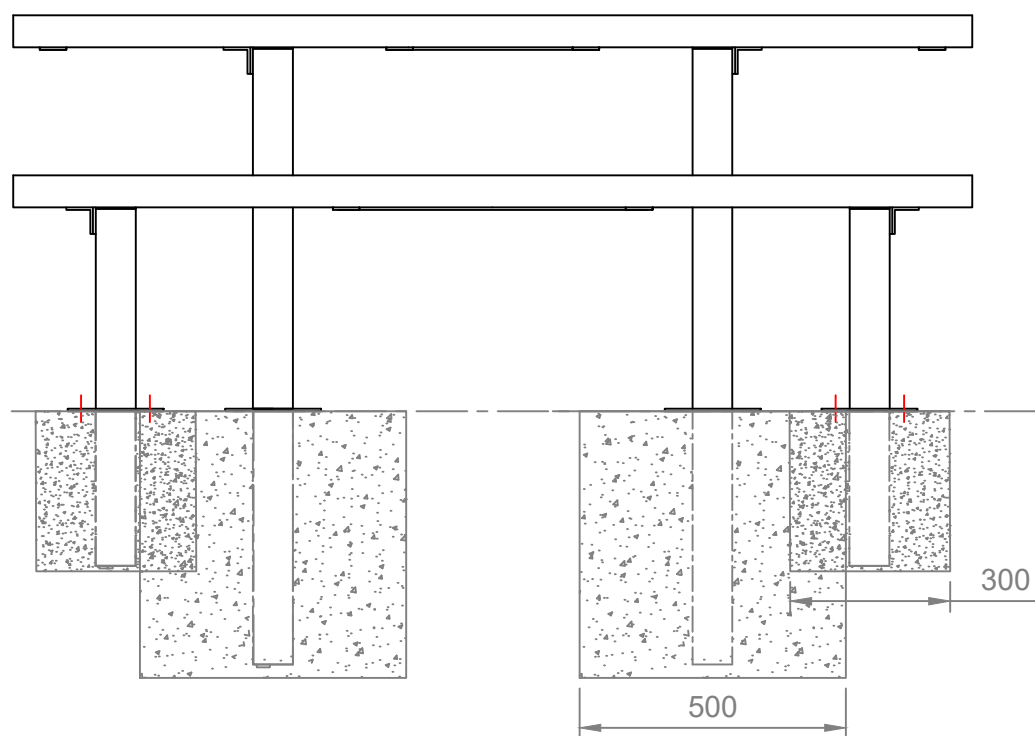

Front view

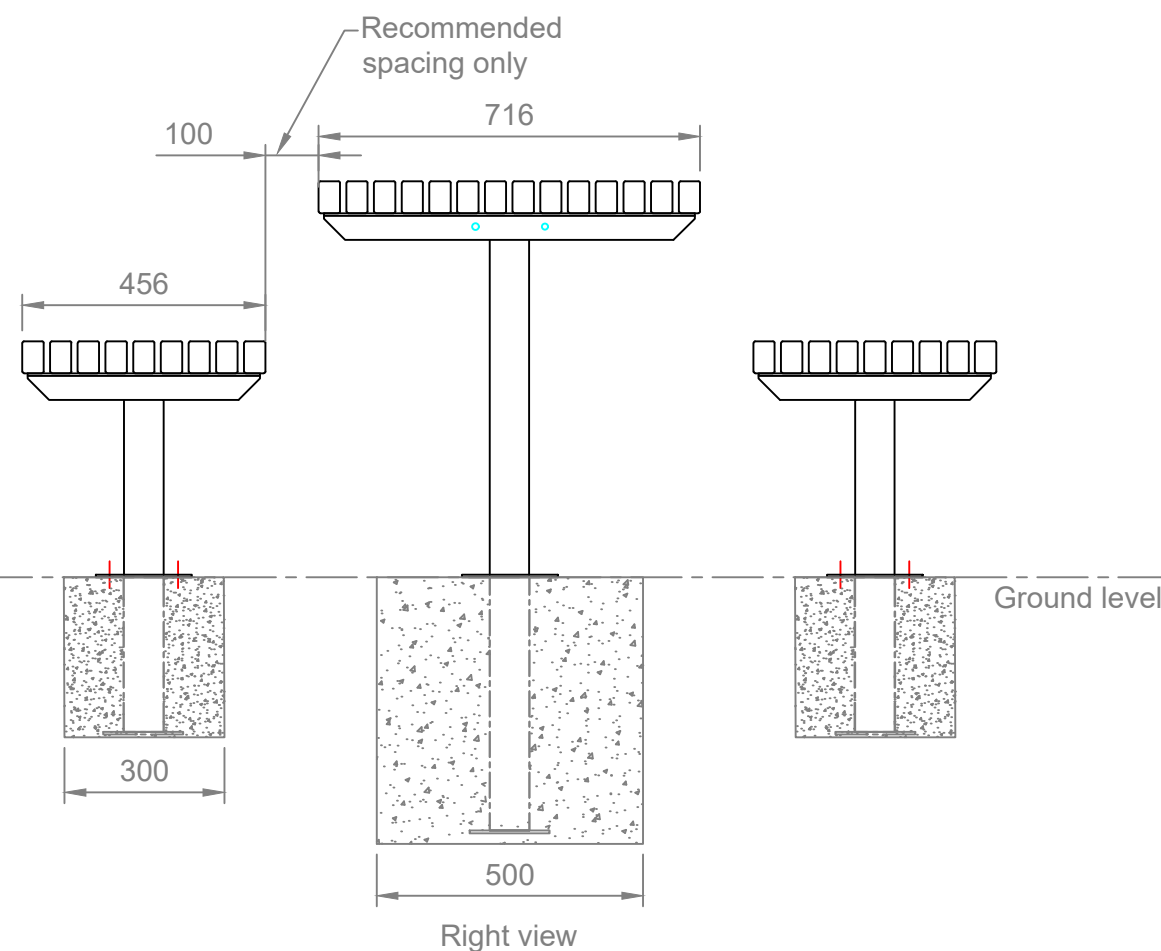

Right view

INSTALLATION DETAILS (Recommendations only)

Concrete footings, 25mPa:

- Two 500x500x500mm minimum footing size for table
- Four (total) 300x300x300mm minimum footing size for benches
- Bolt down to footings with 4x M12x75mm (per leg) Dynabolts or similar
- For extended leg option, set furniture into footings

or

Concrete slab, 25mPa:

- One 1900x1930x100mm (minimum) thick slab recommended

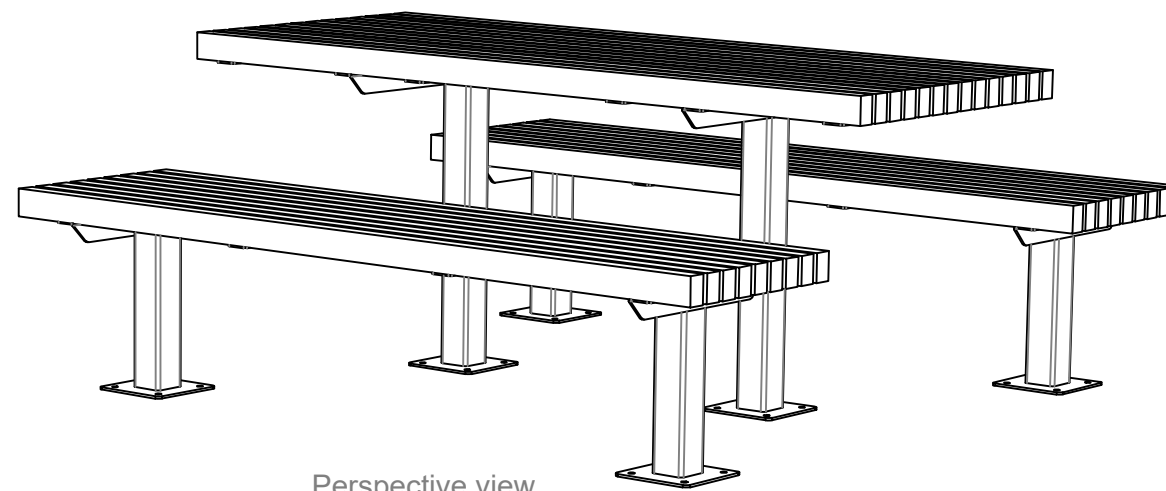

Perspective view



Commercial Systems Australia Pty. Ltd.

42 Orchard Street, Kilsyth South, VIC
 phone: (03) 9723 4111
 fax: (03) 9723 3494
 email: design@commercialsystems.com.au

Model Code: TM4054
 Model Description: Vertical Slat Table

Drawing: CS0073

Sheet Number: -
 Sheet Description: Installation - Setting

Drawn By: G.Smith
 Date Drawn: 07.07.2009
 Revision Number: 5

SCALE 1:1

ALL DIMENSIONS IN MILLIMETERS
 UNLESS OTHERWISE STATED
 ALL PARTS CENTRED UNLESS SPECIFIED

TOLERANCES
 X +/- 1mm
 X.X +/- 0.5mm
 X.XX +/- 0.05mm