

CONCRETE TO BE INSTALLED BY CUSTOMER
 APPROX INFILL VOLUME:
 BASE PLATED = 0.016m³
 EXTENDED LEG = 0.021m³

FRAME MATERIAL: MILD STEEL
 FINISH: POWDERCOATED
 OR HOT DIPPED GALVANISED
 COLOUR: AS PER ORDER

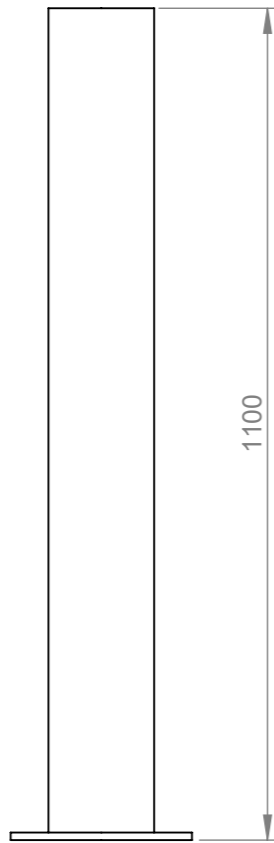

BASE PLATE

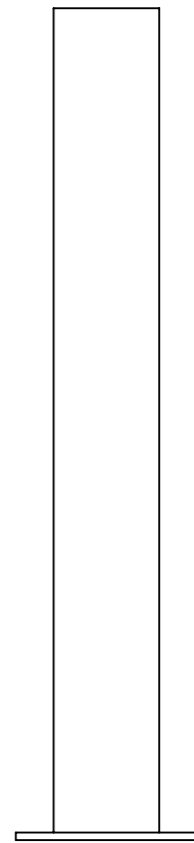
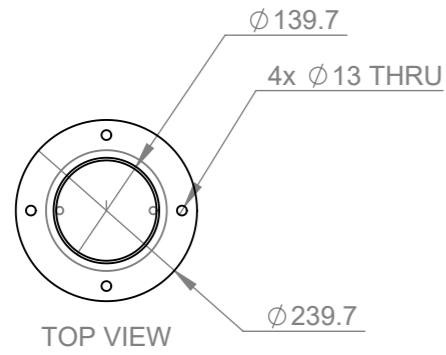
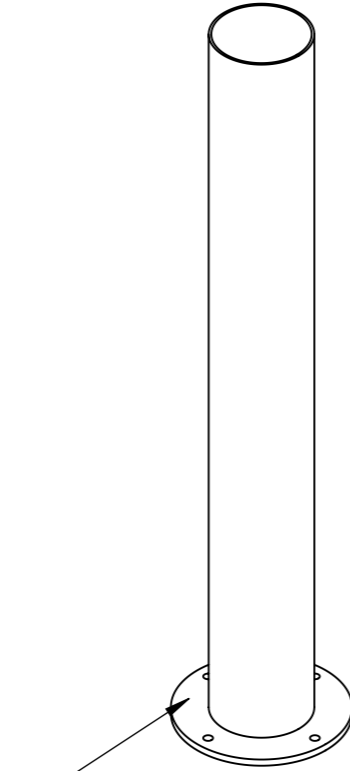

FIXING METHOD
 M12 BOLT DOWN, TOTAL 4 REQ (NOT SUPPLIED)

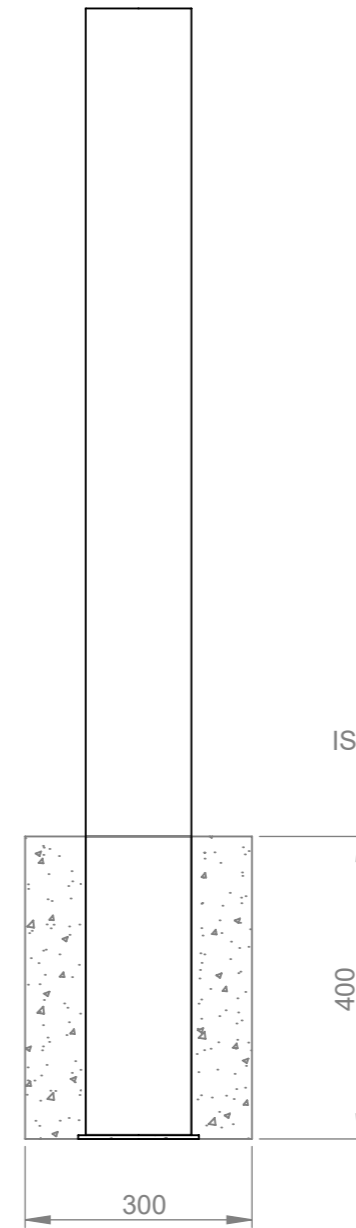
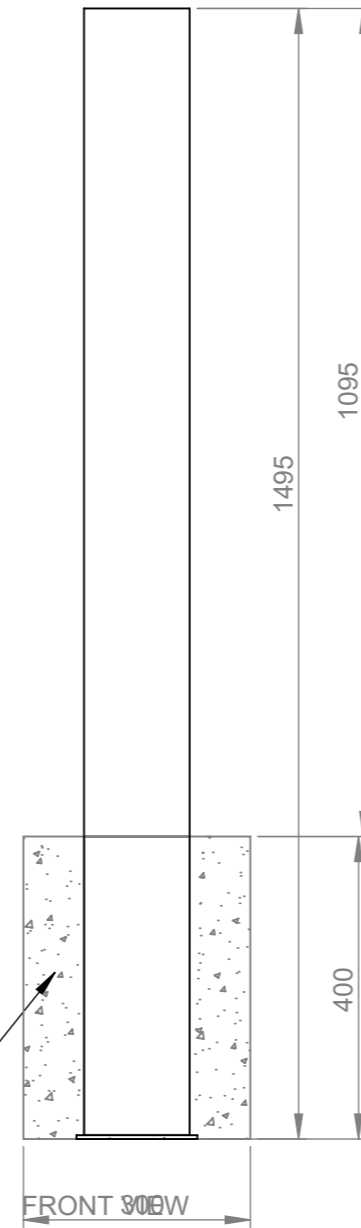
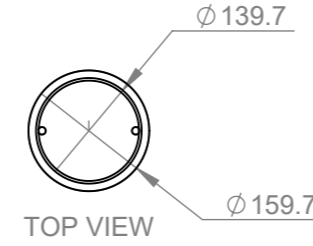

EXTENDED LEG

FIXING METHOD
 EXTENDED LEG INTO CONCRETE FOOTING
 MINIMUM 300X300X400MM FOOTING
 CONCRETE FOOTING, 25MPA:

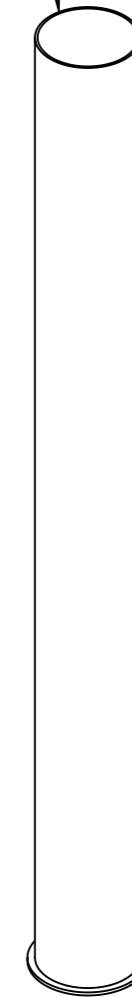

ISOMETRIC VIEW

 Commercial Systems Australia Pty. Ltd.
 42 Orchard Street, Kilsyth South, VIC
 phone: (03) 9723 4111
 fax: (03) 9723 3494
 email: design@commercialsystems.com.au

Model Code: SB2005
 Model Description:
 Concrete Filled Traffic Bollard

Drawing: CS5585
 Sheet Number: 1
 Sheet Description: Overview Drawing

Drawn By: GS
 Date Drawn: 14/02/2019
 Revision Number: 0
 Revision Details: -
 SCALE 1:10

ALL DIMENSIONS IN MILLIMETERS
 UNLESS OTHERWISE STATED
 ALL PARTS CENTRED UNLESS SPECIFIED

TOLERANCES
 X +/- 1mm
 X.X +/- 0.5mm
 X.XX +/- 0.05mm