

**INSTALLATION DETAILS (Recommendations only)**  
 Concrete footings, 25mPa:  
 - One 500x500x150mm minimum footing size  
 - Bolt down to footings with 4x M12x100mm Dynabolts or similar

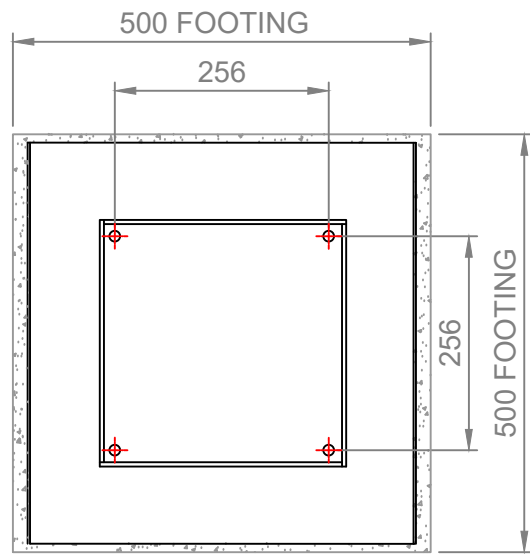

Section A-A

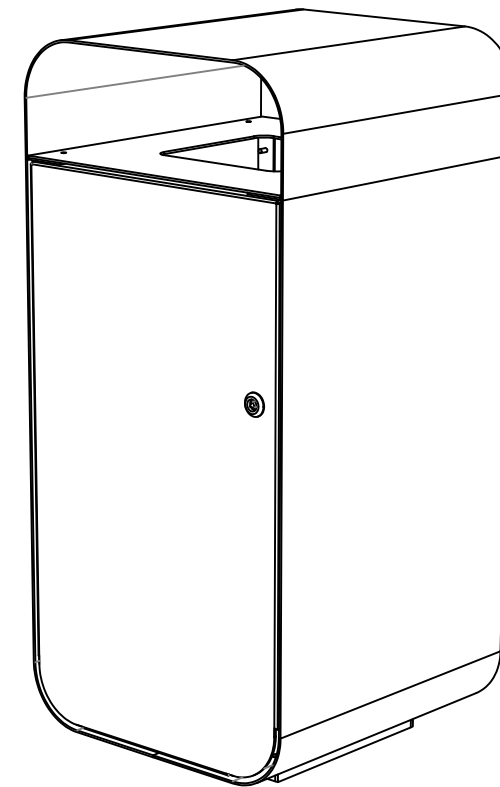
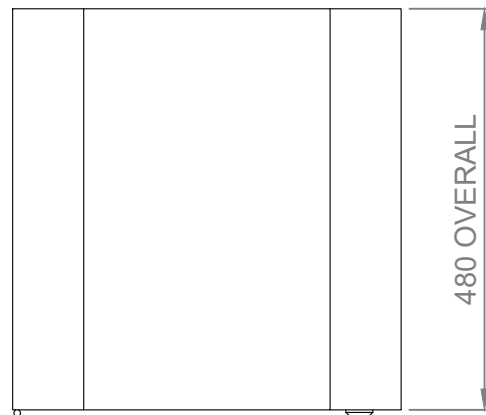

Perspective view

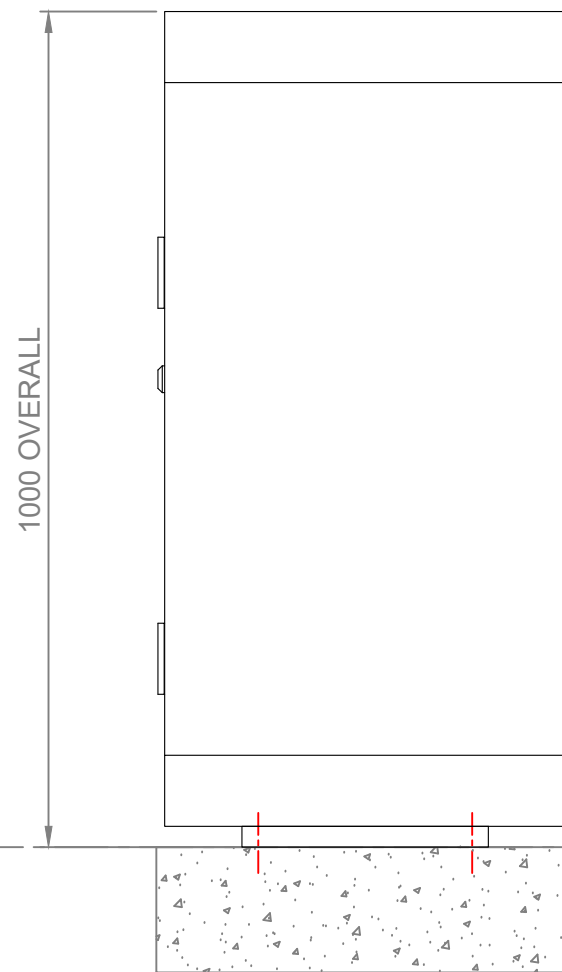
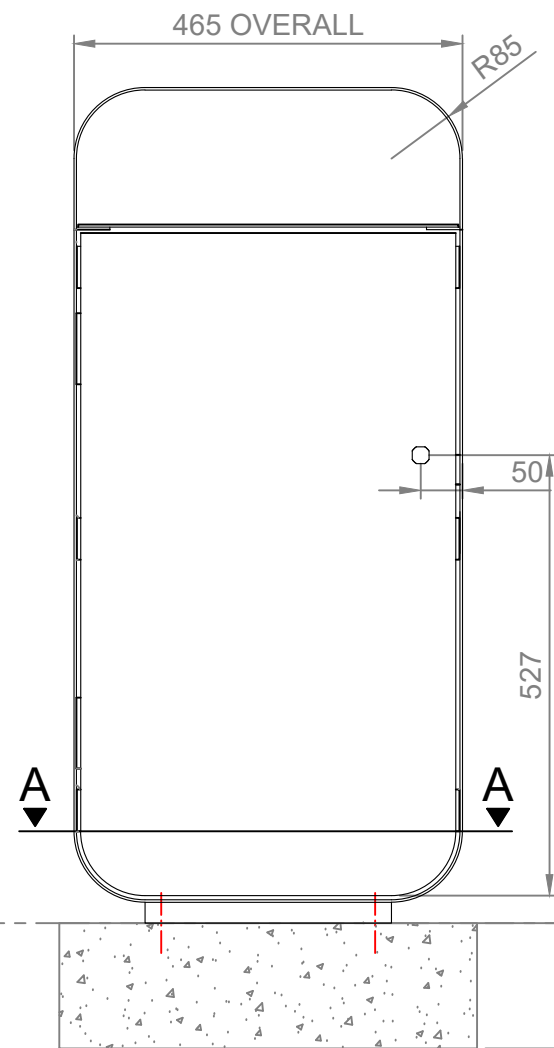

Right view

Ground level



Commercial Systems Australia Pty. Ltd.  
 42 Orchard St, Kilsyth South, VIC  
 phone: (03) 9723 4111  
 fax: (03) 9723 3494  
 email: design@commercialsystems.com.au

Model Code: LR6537  
 Model Description: City Litter Receptacle

**Drawing: CS3147**

Sheet Number: 0  
 Sheet Description: Install Guide

Drawn By: K.Sohanpal  
 Date Drawn: 07.12.2016  
 Revision Number: 0

SCALE 1:1

ALL DIMENSIONS IN MILLIMETERS  
 UNLESS OTHERWISE STATED  
 ALL PARTS CENTRED UNLESS SPECIFIED

TOLERANCES

X	+/- 1mm
X.X	+/- 0.5mm
X.XX	+/- 0.05mm