

TOP VIEW

INSTALLATION:

TOOLS REQUIRED: 1 X HAMMERDRILL WITH A 12MM MASONRY DRILL BIT. 4 X M 12 X 50 DYNABOLTS.

SIT THE ENCLOSURE IN THE REQUIRED LOCATION, OPEN THE DOOR AND MARK THE POSITIONS OF THE FOUR DYNABOLTS (SHOWN IN SECTION A-A. CLEAN OUT THE DRILLED HOLES AND MOVE THE ENCLOSURE BACK INTO POSITION. INSERT THE DYNABOLTS INTO THE GROUND AND TIGHTEN THE NUT 2 TO 3 TIMES.

ADJUSTMENT:

TOOLS REQUIRED: 1 X 5mm ALLEN/HEX KEY. 1 X 13mm SOCKET & RATCHET OR A 13mm SPANNER.

AFTER THE DYNABOLTS ARE TIGHTENED, THE ENCLOSURE HAS TO BE LEVELLED. THERE IS 40mm OF HEIGHT (3° GROUND LEVEL) ADJUSTMENT IN THE ENCLOSURE. IF THE GROUND LEVEL DROP EXCEEDS THIS THEN THE SURFACE MUST BE LEVELLED BEFORE INSTALLATION.

LOOSEN THE LEVELLING BOLTS ONE AT A TIME, ADJUST THE HEIGHT AS REQUIRED AND RE-TIGHTEN THE BOLT. TO CHECK THAT THE ENCLOSURE HAS BEEN LEVELLED CORRECTLY, THE DOOR MUST CLOSE AND LATCH EASILY. THE GAP AROUND THE DOOR MUST BE EVEN (SEE FRONT VIEW).

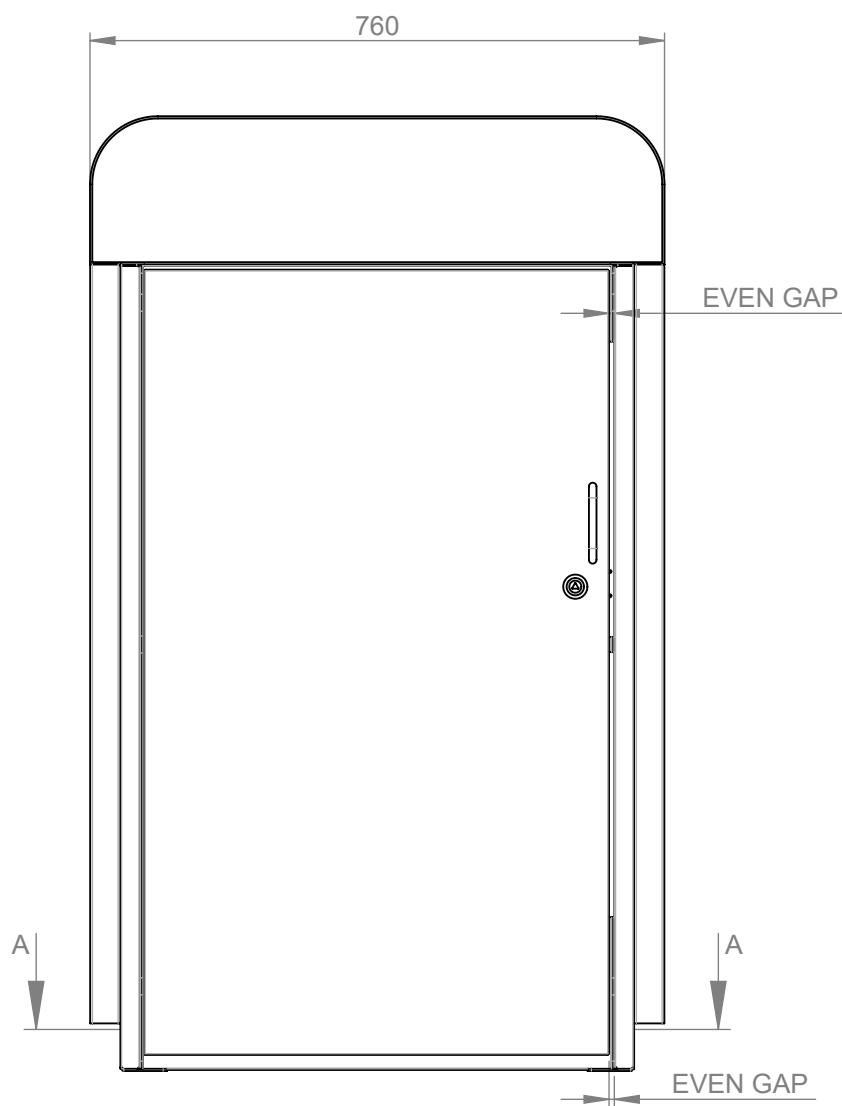

FRONTVIEW

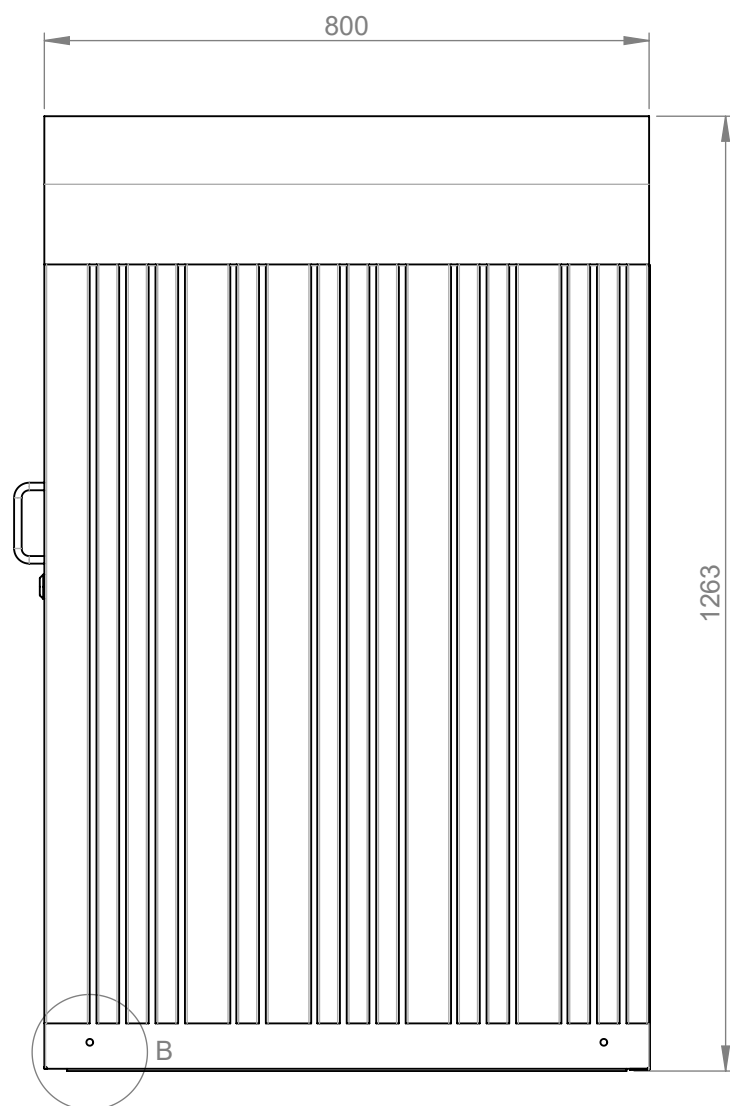

RIGHT VIEW

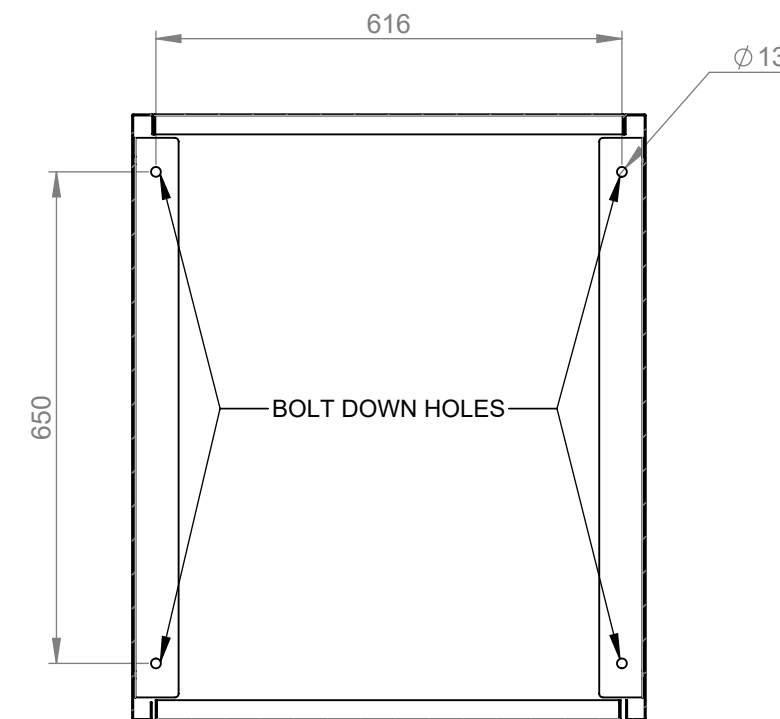

SECTION A-A

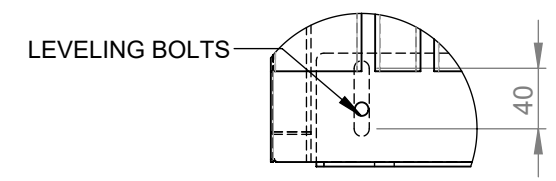

DETAIL B
SCALE 1 : 5



Commercial Systems Australia Pty. Ltd.

42 Orchard Street, Kilsyth South, VIC
phone: (03) 9723 4111
fax: (03) 9723 3494
email: design@commercialsystems.com.au

SCALE 1:1